



Professional

GTA 2600

Robert Bosch Power Tools GmbH
70538 Stuttgart
GERMANY

www.bosch-pt.com

1 609 92A 9Y7 (2026.02) PS / 11



1 609 92A 9Y7



en Original instructions

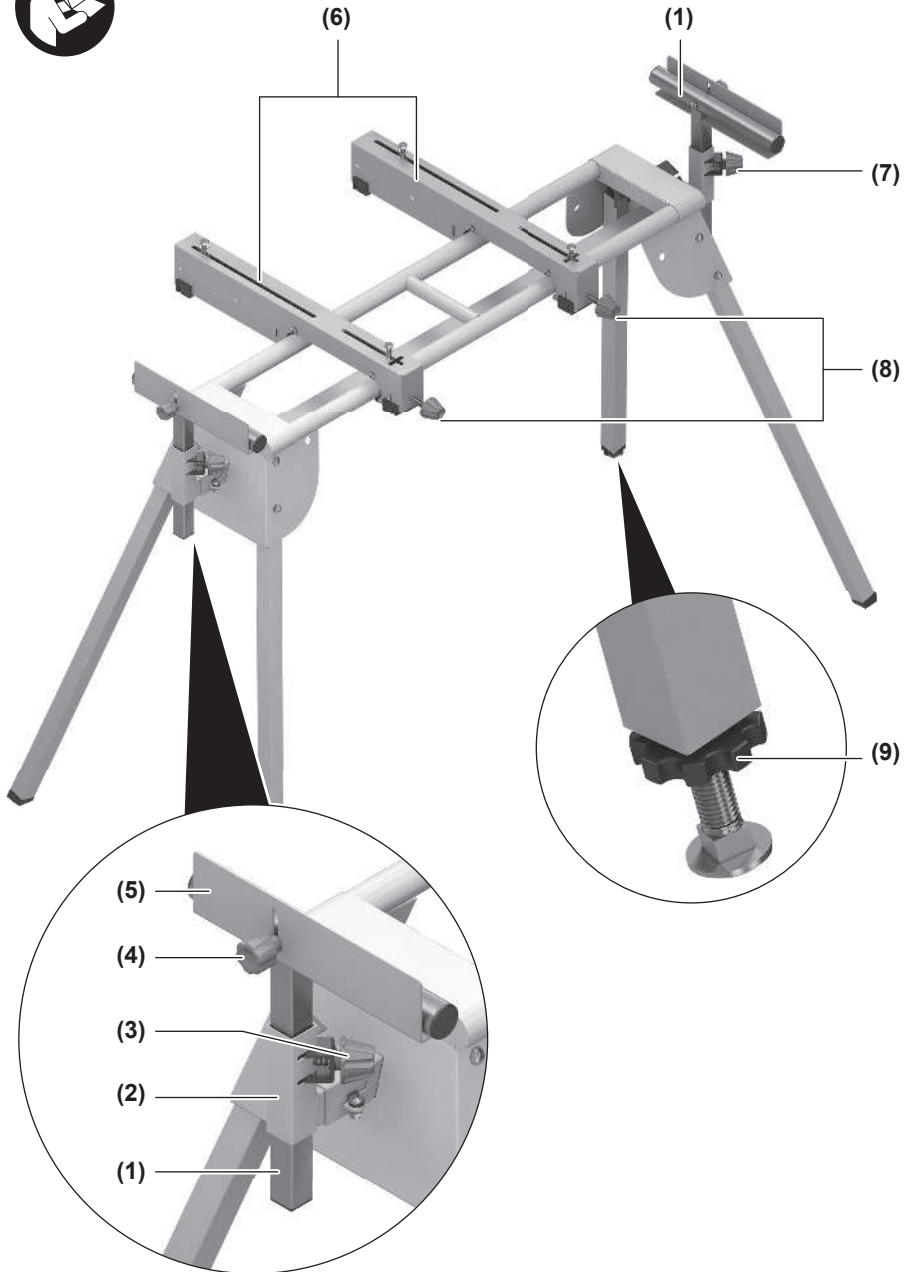

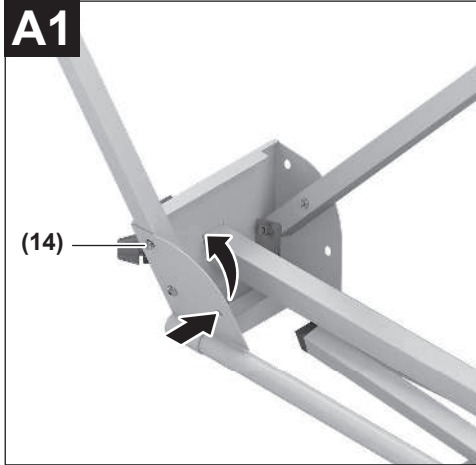
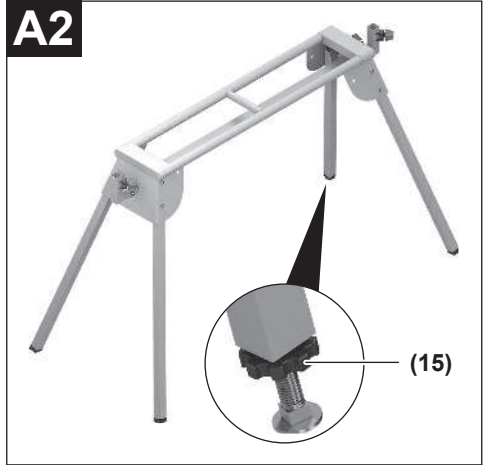
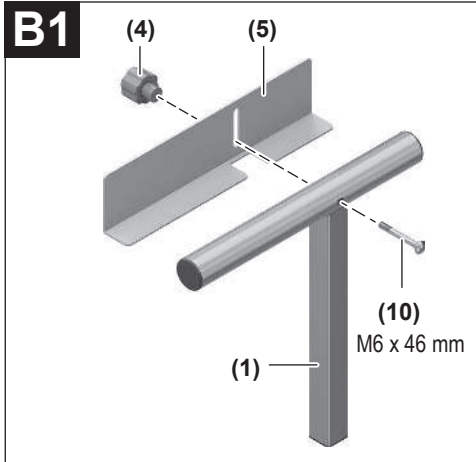
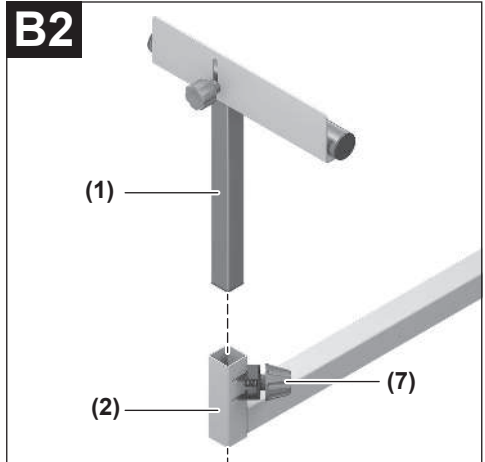
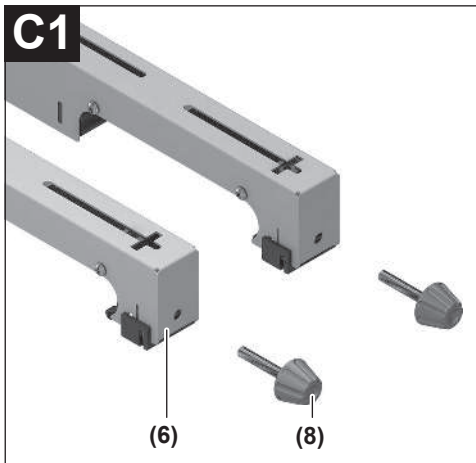
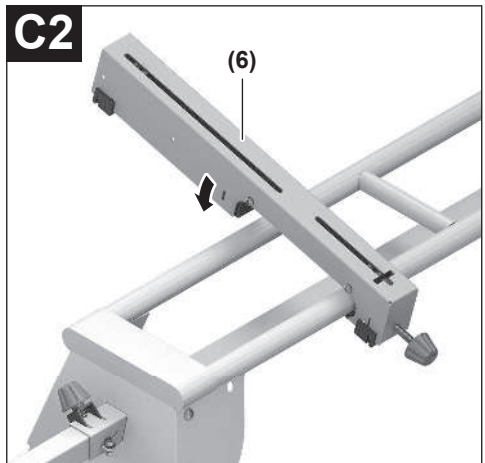

A1**A2****B1****B2****C1****C2**

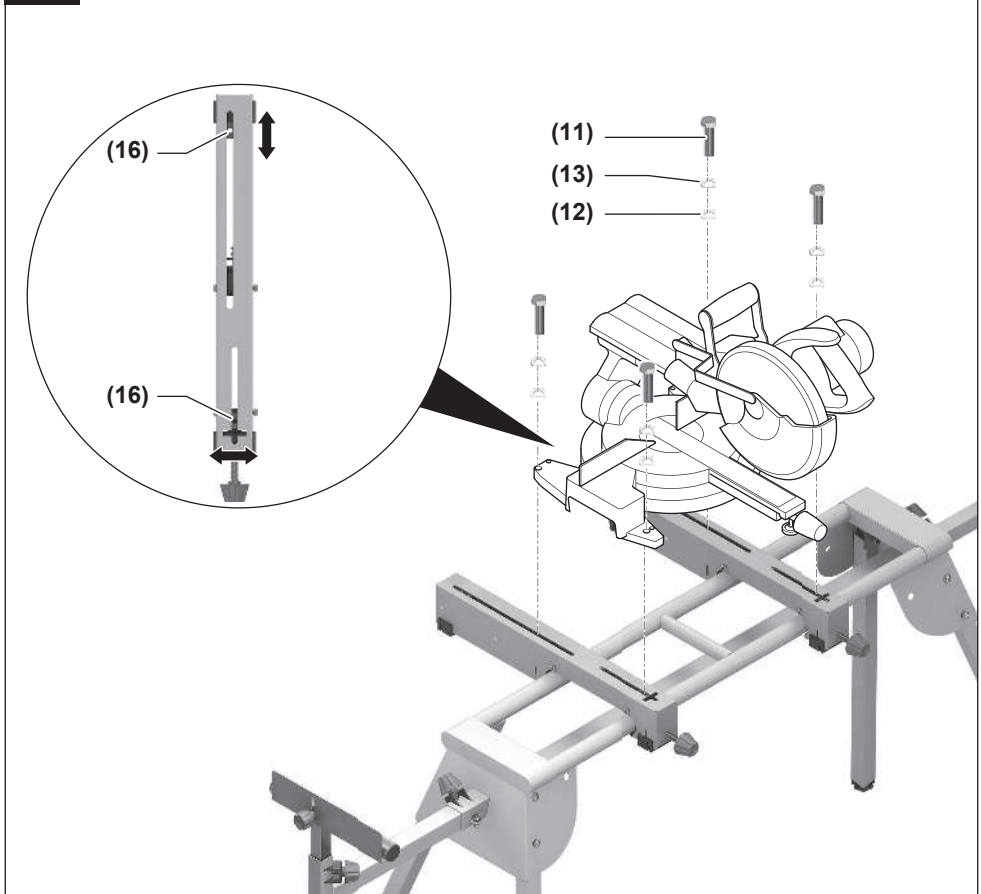
C3**C4****D**

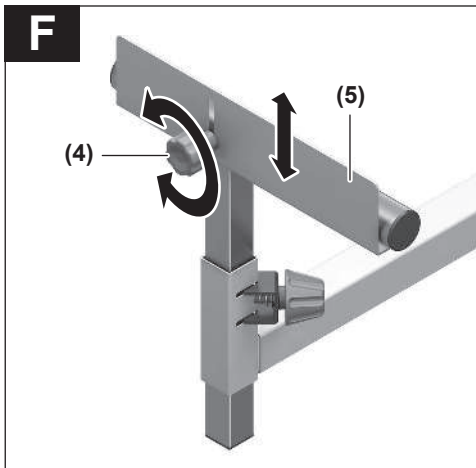
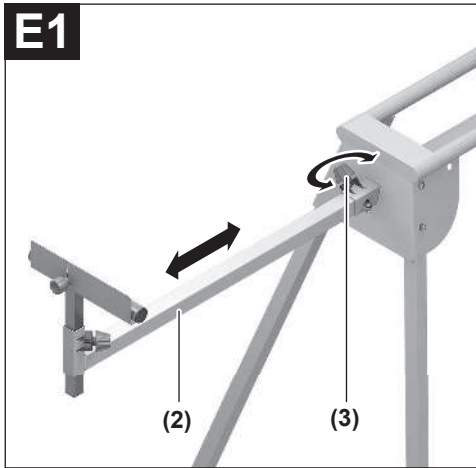

English

Safety Instructions

General Safety Instructions



Read all the warnings and instructions included with the saw stand or the power tool you intend to mount on it. Failure to observe the safety and general instructions may result in electric shock, fire and/or serious injury.

Safety Instructions for Saw Stands

- ▶ **Disconnect the plug from the power source and/or remove the battery from the power tool before making any adjustments to the power tool or changing accessories.** Accidents can occur when power tools are started unintentionally.
- ▶ **Assemble the saw stand properly before mounting the power tool.** Correct assembly is important to prevent the risk of collapsing.
- ▶ **Firmly secure the power tool to the saw stand before using it.** You may lose control of the power tool if it slips on the saw stand.
- ▶ **Place the saw stand on a firm, flat, horizontal surface.** If there is a chance that the saw stand will slip or wobble, the safe and steady machining of the workpiece cannot be guaranteed.
- ▶ **Do not overload the saw stand or climb or stand on it.** Overloading or standing on the saw stand can raise its centre of gravity, causing it to tip over.
- ▶ **Ensure that all screws and connecting pieces are tightly fastened during transport and when carrying out work. The holder sets for the power tool must always be securely locked.** Loose connections can cause instability and inaccurate sawing.
- ▶ **Only install and remove the power tool when it is in the transport position (for information on the transport position, also refer to the operating instructions for the relevant power tool).** Otherwise the power tool may have an such unfavourable centre of gravity that you will not be able to hold onto it securely.
- ▶ **Operate the power tool fastened to the holder set only on the saw stand.** Without the saw stand, the holder set with the power tool is not secure and can tilt.
- ▶ **Ensure that long and heavy workpieces do not unbalance the saw stand.** The free end of long and heavy workpieces must have something placed underneath it or be supported.
- ▶ **When pushing together or pulling apart the saw stand, do not put your fingers near the points of articulation.** There is a risk of fingers being crushed.

Symbols

The following symbols may provide you with important information about the use of your saw stand. Please take note of these symbols and their meaning. Knowing what these symbols mean will help you to use your saw stand more effectively and more safely.

Symbols and their meaning



The maximum load bearing capacity (power tool + workpiece) of the saw stand is **160 kg**.

Product description and specifications

Intended Use

The saw stand is intended for holding the following Bosch benchtop saws (stand **2026.01**):

- EXCM341-305GD (3 601 M23 8..)
- GCM 8 S (3 601 L16 0..)
- GCM 8 SJ (3 601 L16 2..)
- GCM 800 S (3 601 L16 1..)
- GCM 80 SJ (3 601 M19 0..)
- GCM 800 SJ (3 601 M19 0..)
- GCM 8 SJL (3 601 M19 1..)
- GCM 8 SDE (3 601 M19 2..)
- GCM 10 (0 601 B20 0..)
- GCM 10 J/GCM 10 M (3 601 M20 2..)
- GCM 10 S (0 601 B20 5..)
- GCM 10 SD (0 601 B22 5..)
- GCM 10 GDJ (3 601 M27 0..)
- GCM 12 (0 601 B21 0..)
- GCM 12 SD (0 601 B23 5..)
- GCM 12 SDE (3 601 M23 1..)
- GCM 12 GDL (3 601 M23 6..)
- GCM 350-216 (3 601 M49 0..)
- GCM 350-254 (3 601 M22 6..)
- GCM 18V-216 D (3 601 M51 0..)
- GCM 18V-216 DC (3 601 M47 0..)
- GCM 18V-254 D (3 601 M51 1..)
- GCM 18V-305 GDC (3 601 M43 0..)
- GTM 12 (3 601 M15 0..)
- GTM 12 JL (3 601 M15 0..)

The saw stand and power tool are intended for cutting boards and profiles.

Product Features

The numbering of the components shown refers to the illustrations on the graphics pages at the beginning of the manual.

- (1) Workpiece support
- (2) Table extension
- (3) Table extension locking knob
- (4) Locking knob for length stop
- (5) Length stop
- (6) Holder set
- (7) Workpiece support locking knob
- (8) Holder set locking knob
- (9) Height-adjustable foot
- (10) Carriage bolt M6 × 46
- (11) Hexagon screw M8 × 38 (fastening of power tool)
- (12) Washer
- (13) Lock washer
- (14) Locking pin
- (15) Lock nut
- (16) Movable nut
- (17) Holder set adjustment screw

Technical Data

Saw stand		GTA 2600
Article number		3 601 M12 3..
Length of saw stand without table extension	mm	1265
Length of saw stand with table extension	mm	2615
Saw stand height	mm	855
Max. load bearing capacity (power tool + workpiece)		
without table extension		
– Holder sets	kg	160
with table extension		
– Holder sets	kg	110
– Per table extension	kg	25
Weight	kg	18.7

Assembly

Items included



See the list of items included at the start of the operating manual.

Check to ensure that all the parts listed below have been supplied before assembling the saw stand:

No.	Designation	Quantity
	GTA 2600 saw stand	1
(6)	Holder set	2
(8)	Holder set locking knob	2
(1)	Workpiece support	2
(5)	Length stop	2
Fastening set consisting of:		
(10)	Carriage bolt M6 × 46	2
(11)	Hexagon screw M8 × 38	4
(12)	Washer	4
(13)	Lock washer	4
(4)	Locking knob for length stop	2

Extra tools required (not included in the delivery):

- Cross-headed screwdriver
- Wrench, adjustable

Assembling the Saw Stand

Carefully remove all parts included in the delivery from their packaging.

Remove all packing material.

Setting Up the Saw Stand (see figures A1–A2)

- Place the saw stand on the floor with legs up.
- Press the locking pin (14) in and swivel the leg up until the locking pin audibly engages again. Repeat this work step with the other three legs.
- Rotate the saw stand into the working position. Make sure that the saw stand is stable and all locking pins have engaged.

A height-adjustable foot (9) helps you to align the saw stand.

- Undo the lock nut (15) and screw the foot in or out until the saw stand is level and all four legs are on the ground.

Fitting the Length Stop and Workpiece Support (see figures B1–B2)

- Screw together the length stop (5) and the workpiece support (1) with the bolt (10) and the locking knob (4).
- Insert the workpiece support (1) into the table extension (2).
- Pull the locking knob (7) to lock the workpiece support.
- Repeat these steps with the second workpiece support.

Preparing the Saw Stand

Preparing holder sets (see figures C1–C4)

- Screw the locking knob (8) into the corresponding hole of the holder set (6).
- Measure the distance **x** between the assembly holes on your power tool.
- Position the holder sets (6) in the centre of the saw stand and at the appropriate distance **x** from each other.
- Tighten the locking knobs (8). This allows the holder sets to be firmly positioned on the saw stand.

Fastening the Power Tool on the Holder Sets (see figure D)

- Bring the power tool into the transport position. Information about the transport position can be found in the operating instructions for the corresponding power tool.
- Position the movable nuts **(16)** in the holder sets so that they match the assembly holes on the power tool.
Note: The cross slot in the holder set **(6)** also allows power tools with offset mounting holes to be secured.
- Screw the holder set **(6)** and power tool together using the hexagon screws **(11)**, lock washers **(13)** and washers **(12)** from the fastening set.

Operation

Working Advice

Always hold the workpiece firmly in place, especially long, heavy pieces. Once the workpiece has been cut, the centre of gravity may be displaced, causing the saw stand to tip over.

Do not overload the saw stand. Always observe the maximum load bearing capacity of the saw stand.

Preparing the workpiece support

The free end of long workpieces must have something placed underneath it or be supported.

Extending the Saw Stand (see figures E1–E2)

The saw stand can be extended on both sides.

- Place your long workpiece on the saw table for the power tool.
- Undo the locking knob **(3)** and pull the table extension **(2)** outwards until it reaches the required length.
- Retighten the locking knob **(3)**.
- Undo the locking knob **(7)** and adjust the height of the workpiece support **(1)** so that your workpiece lies flat.
- Retighten the locking knob **(7)**.

Sawing workpieces of the same length (see figure F)

The length stop **(5)** can be used for easily sawing workpieces to the same length.

- Undo the locking knob **(4)** and position the length stop **(5)** at the required distance from the saw blade of the power tool.
- Retighten the locking knob **(4)**.

Checking and adjusting the basic settings

- Remove the power tool from the holder sets.

To ensure safe use, the basic settings of the saw stand must be checked and adjusted as necessary after intensive use. Experience and suitable special tools are required for this.

Adjusting the Bracket of the Holder Set (see figure G)

After making intensive use of the saw stand, you may need to adjust the bracket that locks the holder set **(6)** on the saw stand using the locking knob **(8)**.

- Turn the holder set **(6)** around.
- If it is not possible to lock the holder set on the work bench despite firmly tightening the locking knob **(8)**, turn the adjustment screw **(17)** **clockwise**. If the holder set does not fit on both rails (front and back) of the saw table at the same time, turn the adjustment screw **(17)** **anticlockwise**.
- Check that the holder set is sitting firmly and correctly and repeat the adjustment if necessary.
- Repeat the steps with the second holder set.

Maintenance and Service

After-Sales Service and Application Service

Great Britain

Tel. Service: (0344) 7360109

GB Importer:

Robert Bosch Ltd.
Broadwater Park
North Orbital Road
Uxbridge
UB9 5HJ

You can find the link to our service addresses and warranty conditions on the last page.

In all correspondence and spare parts orders, please always include the 10-digit article number given on the nameplate of the product.

Disposal

Saw stands, accessories and packaging should be recycled in an environmentally responsible manner.

Servicekontakte
Service Contacts
Contacts de Service
Contactos de Servicio



<https://www.bosch-pt.com/serviceaddresses>

Garantiebedingungen
Guarantee Conditions
Conditions de Garantie
Condiciones de Garantía



<https://www.bosch-pt.com/guarantee/202601>